

The information contained in this drawing is the sole property of CMS Coil Winding Specialist. Any reproduction in part or whole without written permission of CMS Coil Winding Specialist is prohibited.

DIMENSIONAL TOLERANCES					
INCHES (MM)					
A	B	C	D	X	
MAX	MAX	TYP	REF	REF	
1.10 [27.94]	0.48 [12.10]	0.50 [12.70]	0.05 [1.29]	0.37 [9.40]	

REVISION HISTORY				SIGN & DATE		
REV	ECN	DESCRIPTION	BY	DATE	CHK	DATE
A	—	PRODUCTION RELEASE	TDK	2/09/04	JLAU	2/9/04
B	—	UPDATED SPEC.	TN	07/11/2020	JL	07/11/2020

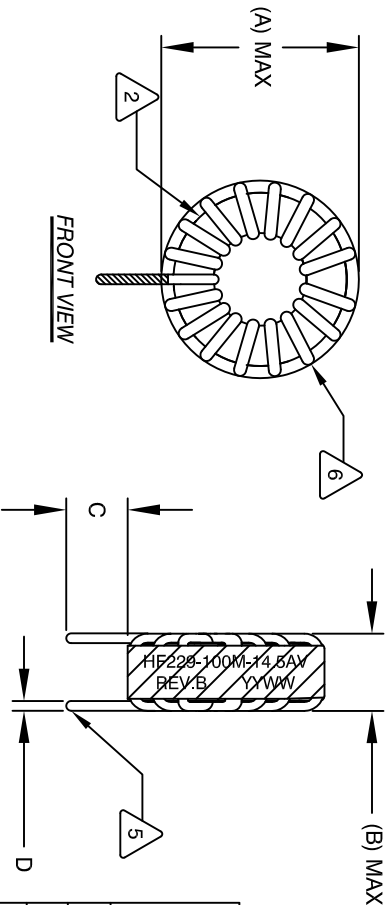
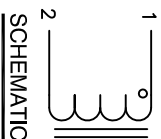

DC BIAS TABLE		
DC BIAS (AMP)	L@ 1KHz (REF)	
0	9.7uH	
1	9.6uH	
2	9.6uH	
4	9.5uH	
6	9.4uH	
8	9.4uH	
10	9.2uH	
12	9.2uH	
14	9.0uH	
14.5	9.0uH	

- BUILD TO ROHS COMPLIANCE AND LEAD FREE.
- USING A PERMANENT MARKING METHOD  
MARK PART NUMBER, REVISION AND DATE CODE  
WRAP INDUCTOR WITH 3M # 79 OR EQUAL
- (I.E. COIL MUST REST FLAT ON PCB). LEADS MUST BE TANGENT TO THE CORE  
REMOVE INSULATION AND TIN LEADS 0.5 INCH, FLUSH WITH THE COIL EDGE
- WIND COILS EVENLY SPACED AROUND THE CORE  
CONSTRUCTION:

THESE SPECIFICATIONS ARE BASED ON LOW RIPPLE CURRENT  
WEIGHT: 50 GRAMS TYPICAL  
SRF : GREATER THAN 10MHZ  
RECOMMENDED AMBIENT OPERATING TEMP: -55°C TO 180°C  
HI-POT TEST FOR WINDING TO CORE ISOLATION = 1250 VDC, 5 SEC.  
CURRENT RATING : 14.5 AMPS, 40°C TEMP. RISE WITH SOME AIR FLOW  
DCR = 8.0 MILLI-OHMS MAX.

- INDUCTOR DC BIAS: SEE TABLE ON THE RIGHT  
INDUCTANCE = 10uH ± 10% @ 0 AMP DC BIAS, 1.0 KHz, 250mV
- SPECIFICATIONS: @ 25°C:

- WIRE: UL RECOGNIZED 200°C RATED MAGNET WIRE  
CORE: POWDERED TOROIDAL CORE, CMS BYTEMARK OR OTHER APPROVED PART
- MATERIAL: UL RECOGNIZED 94V-0 FOR FLAMMABILITY, RATING CLASS B (130°C MIN.) REQUIRED  
ANY TOLERANCE. THIS DIM. CAN VARY A LITTLE FROM PART TO PART.  
\*TYP\* IN DIM. TABLE REFERS TO A NON-CRITICAL TYPICAL (AVERAGE) DIM. WITHOUT  
NOTES: UNLESS OTHERWISE STATED, READ NOTES FROM BOTTOM UP.  
CAGE CODE: 5DME2

#### MOUNTING HOLES PATTERN

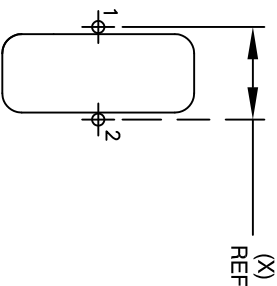

3 HOLES PATI TEN						
CODE		MFG. P/N		DESCRIPTION		ITEM NO.
IDENT						
PARTS LIST						
AUTOCAD		X		COLIWS COM, INC www.coliws.com CWS Coil Winding Specialist. 353 WEST GROVE AVE. ORANGE, CA 92665		
SOLIDWORKS						
SIGN		DATE				
DRAWN		2/8/04				
TDK		2/8/04				
CHECKED		2/8/04		TITLE: TOROIDAL POWER INDUCTOR 10uH, 14.5 Amps, Vertical		
ENGR.		2/8/04				
KSUM		2/8/04				
APPR.		2/8/04				
JLAU		2/8/04				
SIZE		DWG. NO.		REV		
B		HF229-100M-14.5AV		B		
SCALE		2=1		SHEET 1 OF 1		